

# SISTEMA MODULARE PER ALLESTIMENTO DI MICROAMBIENTI AD USO ABITATIVO

Laurea in Disegno Industriale e Ambientale  
a.a. 2013/2014  
Sessione invernale 9 Marzo 2015

Laureanda: Silvia Spinozzi  
Relatore: Arch. Andrea Lupacchini



Scuola di  
Architettura e  
Design  
*Eduardo Vittoria*

*«Viviamo in un mondo in continua trasformazione. Siamo catapultati in un ordine globale che sta estendendo i suoi effetti su tutti noi»*

*(Il mondo che cambia, Giddens)*



**COME SARA' LA CASA DEL FUTURO?**

...nel cinema



*Il ragazzo di campagna*, Castellano e Pipolo, 1984



*Il quinto elemento*, Luc Besson, 1997



...nella concept-art



*Total recall*, Ed Natividad, Andy Chung e Stephan Martiniere, 2012

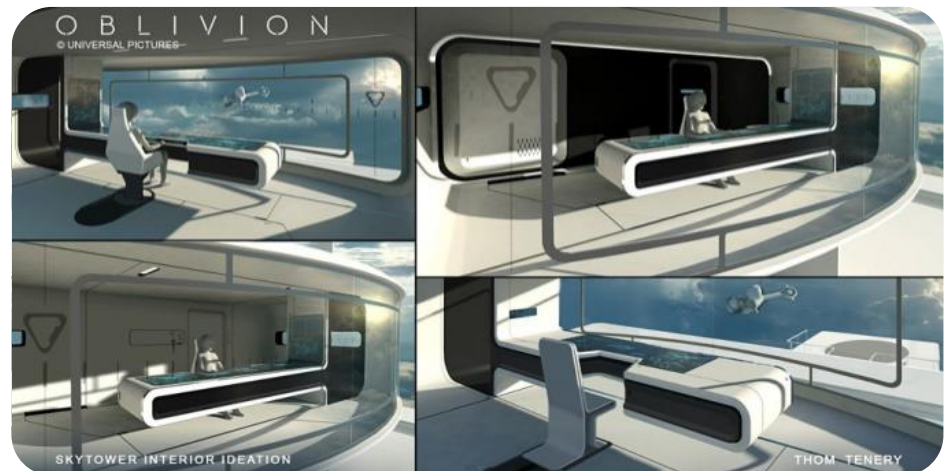

*Oblivion*, Thom Tenert, 2013

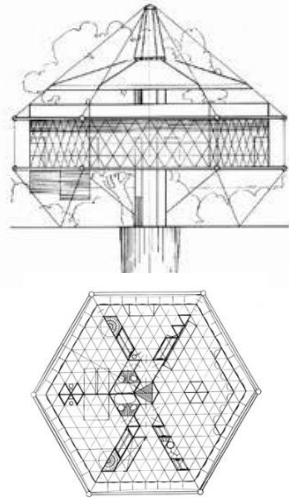
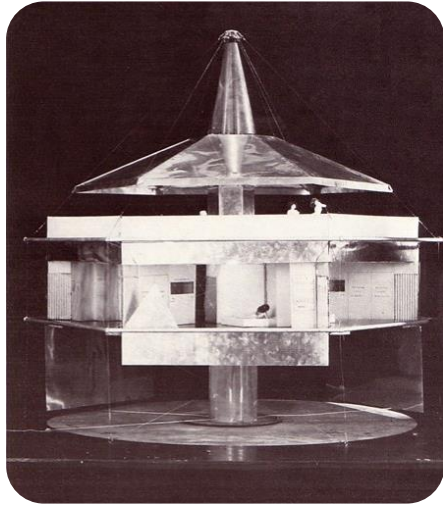

*4-D Dymaxion house, Buckminster Fuller , 1927*

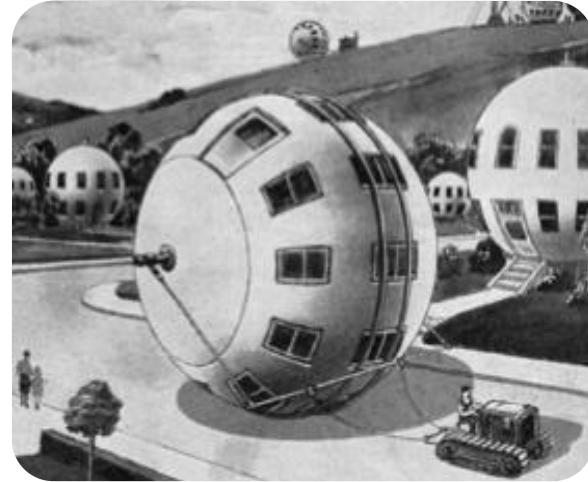

*Casa mobile, nella rivista  
Everyday Science and Mechanics , 1934*

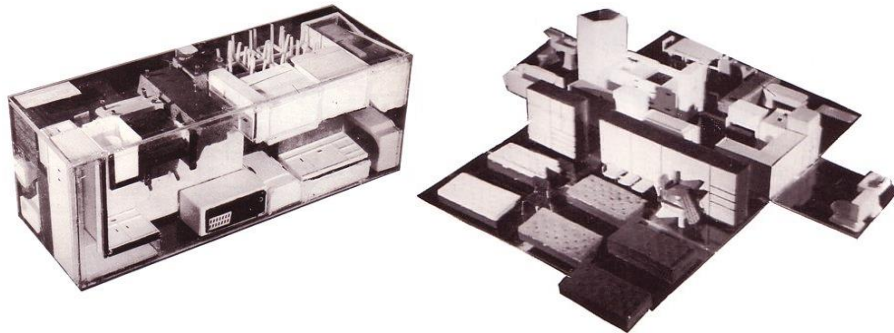

*Casa pieghevole, Buckminster Fuller , 1948*



*Futura – casa ufo, Matti Suuronen, 1968*

...nell'architettura



*The face house*, Roberto Semprini, 2008



*40msq*, Paolo Badetti, 2008



*Hivehaus*, Barry Jackson, 2013



*Rhome for denCity*, Chiara Tonelli, 2014

# I microambienti ...camper e roulotte

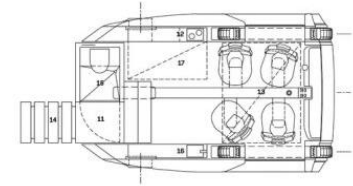
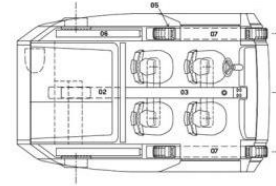

*Odorico Pordenone, Jakub Novak*

*Ecco camper, NAU Design*

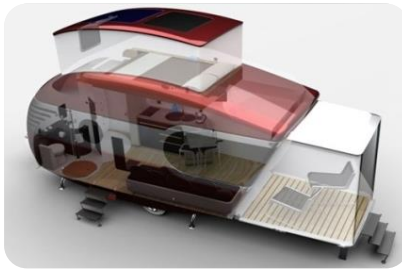

*Retro moderna camper, Bob Villa*



*Romotow, Gen-Y*

...non dotati di ruote

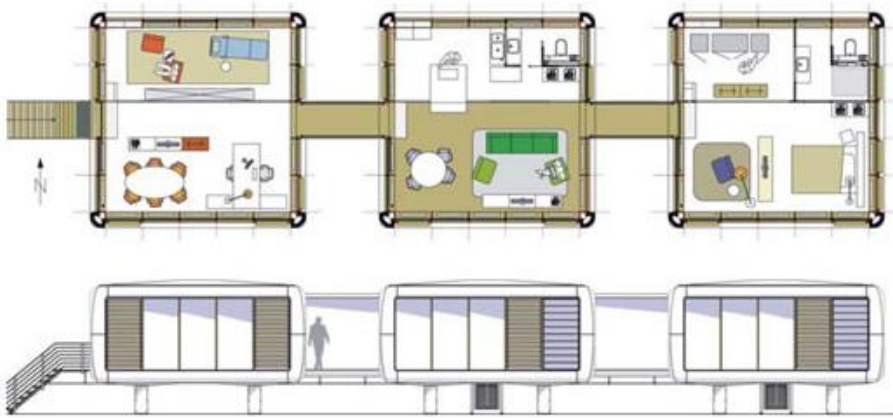

*Loft cube*, Werner Aisslinger



*Miro Compact House*, Richard Horden

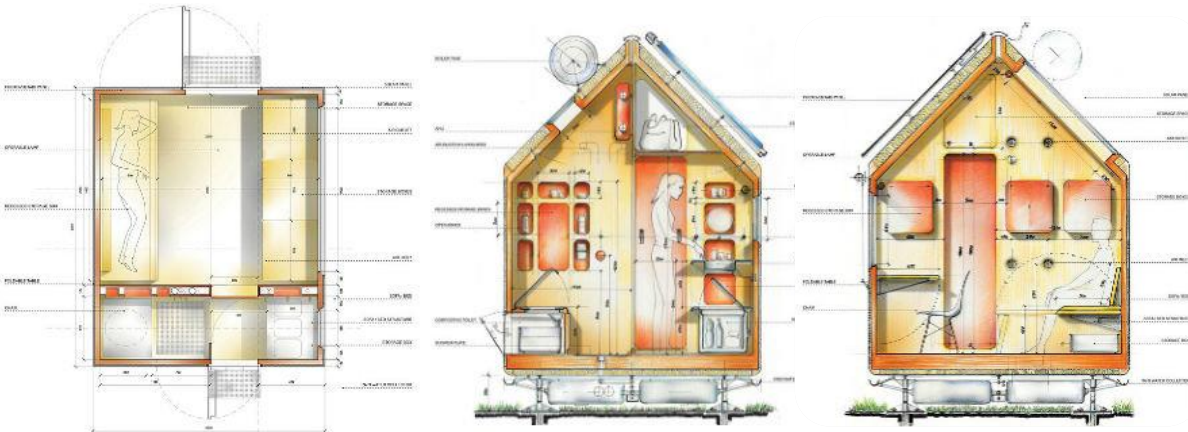

*Diogene*, Renzo Piano





POLIFUNZIONALE



FLESSIBILE

*As if from nowhere, Orla Reynolds*

casa del futuro



GREEN



*Zero House, Specht-Harpman*

DOMOTICA

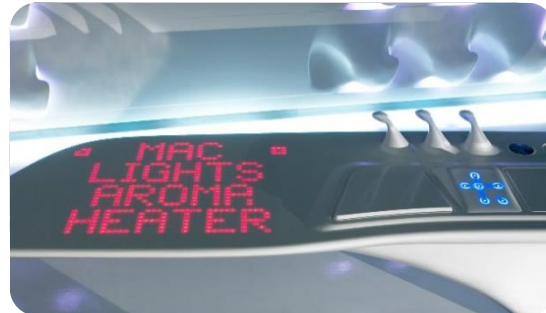

*Z.Island, Zaha Hadid*

COLLETTIVA



# Classificazione dei microambienti a seconda della loro ORGANIZZAZIONE INTERNA

sistema PERIMENTRALE

sistema LIBERO

sistema a BLOCCHI SCORREVOLI

sistema a ROTAZIONE

sistema a ROTAZIONE VERTICALE

sistema a PAVIMENTO

sistema a SOFFITTO

# sistema PERIMENTRALE

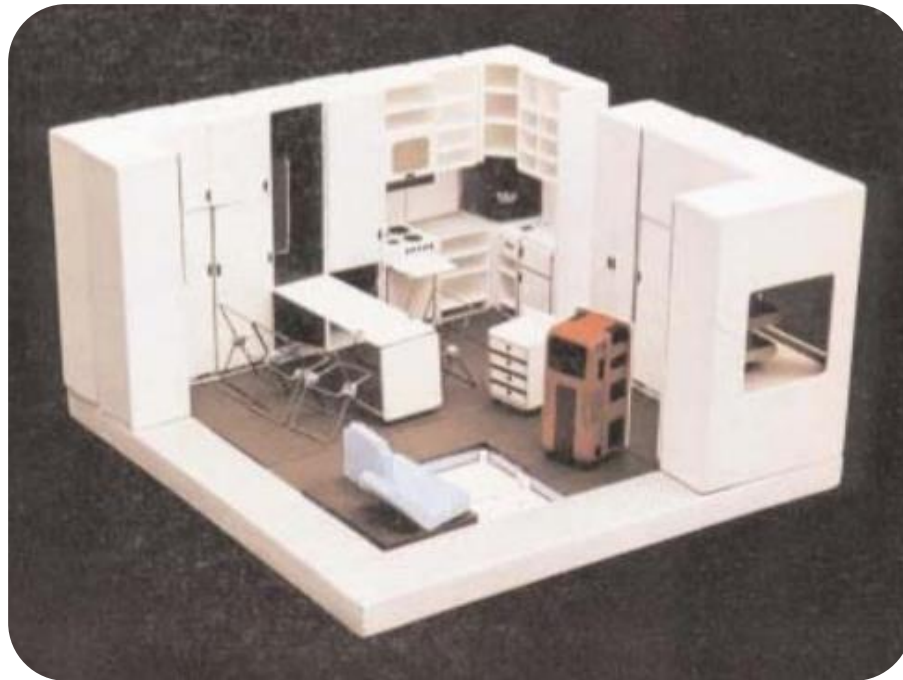

*Elementi modulari attrezzati per arredamento di spazi interni, Gianantonio Mari*



*Lego House, Barbara Appallonni .*

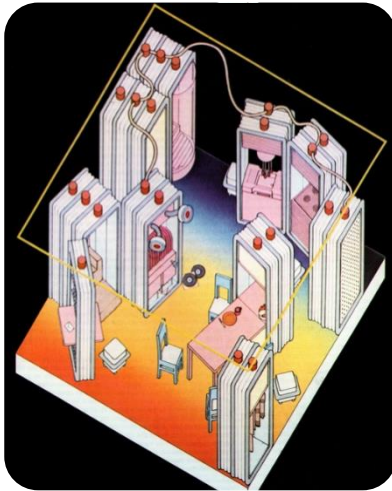

*Cubitat*, David Wex, Mark Reeve e designer Luca Nichetto



*House environment*, Ettore Sottsass



*Minikitchen*, Boffi

*Sheer*, Gatto Kitchen

# sistema a BLOCCHI SCORREVOLI



*Total furnishing unit, Joe Colombo*

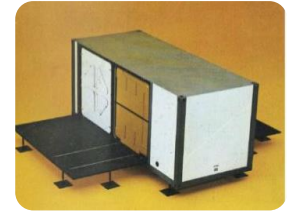
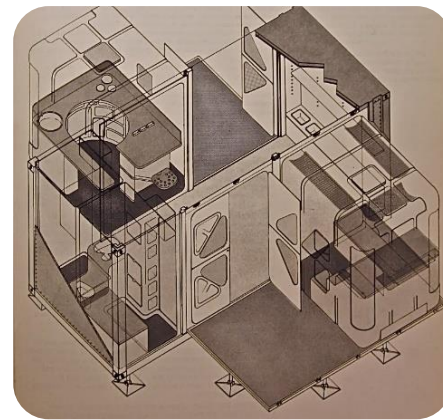

*Unità d'emergenza, Zanuso e Richard Sapper*



*Elastic Living, Clei*

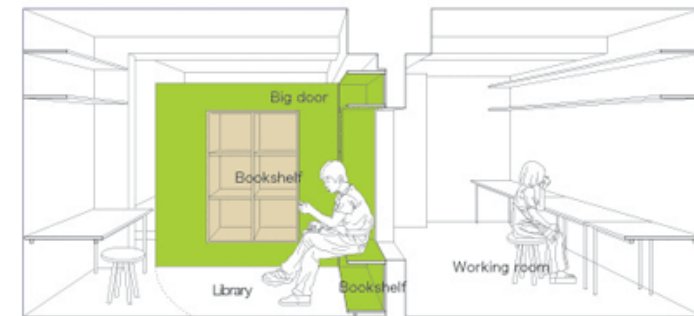
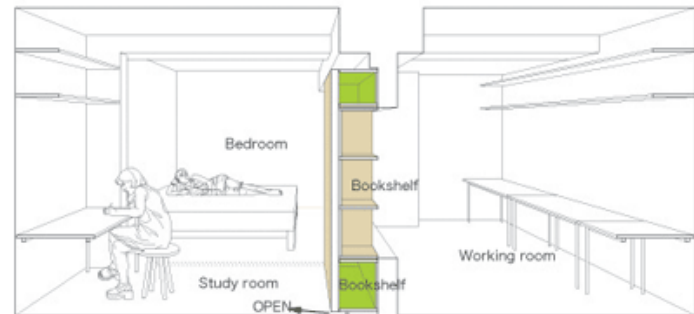

*Switch, Yuko Shibata*

# sistema a ROTAZIONE



*Treestyle, Antonio Giacometti*

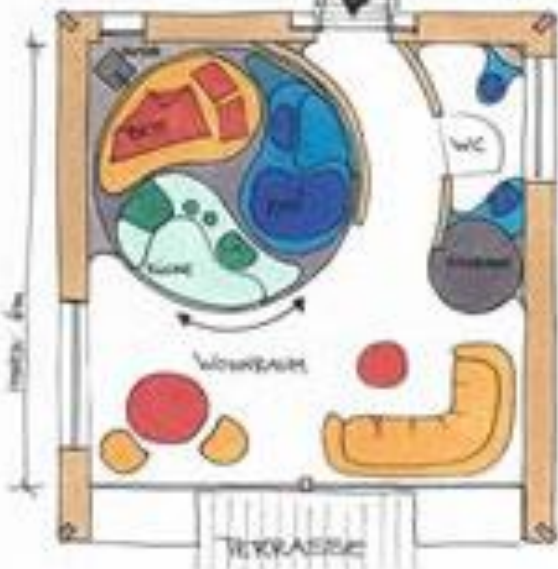

*Rotor House, Luigi Colani*



*Rotator, Ron Arad e Jean Michel Wilmotte*

# sistema a ROTAZIONE VERTICALE

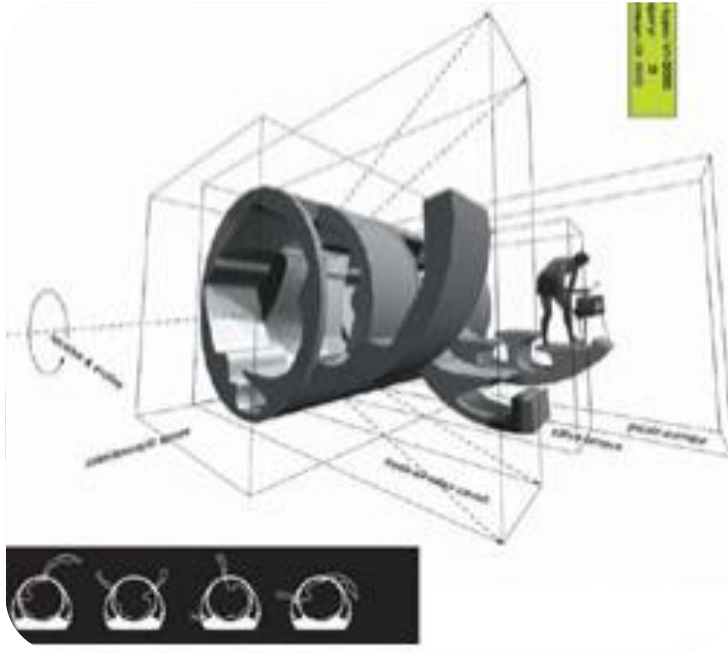

*Roll it*, università di Karlsruhe



*Turn on*, ditta austriaca AllesWirdGut

# sistema a PAVIMENTO



*Elementi modulari attrezzati per arredamento di spazi interni, Gianantonio Mari*

# sistema a SOFFITTO

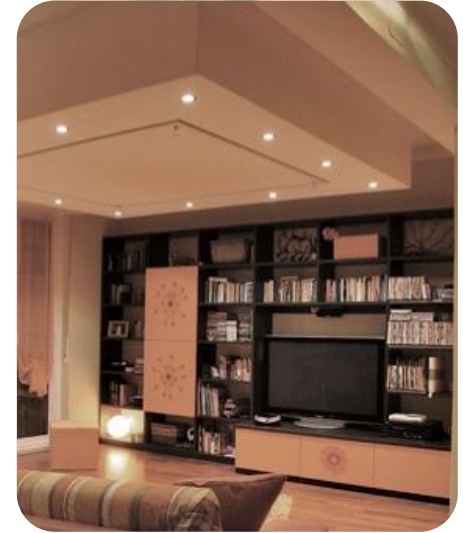

*Didomestic*

*BedUpDown, 2G DESIGN*



sistema LIBERO

SISTEMA MODULARE  
PER ALLESTIMENTO  
DI MICROAMBIENTI  
AD USO ABITATIVO

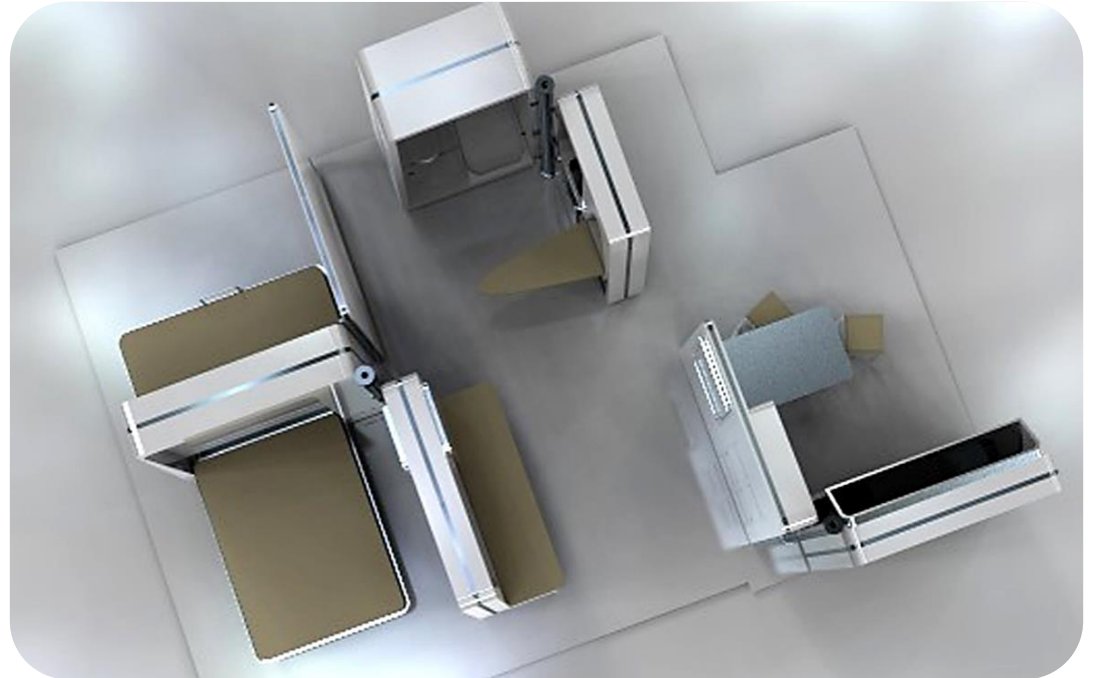

GIORNO

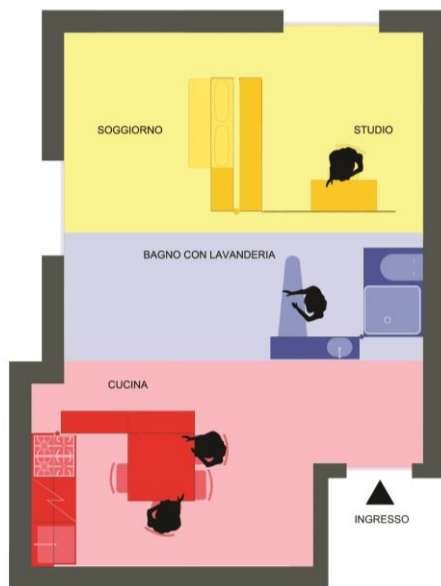

NOTTE



OSPITI

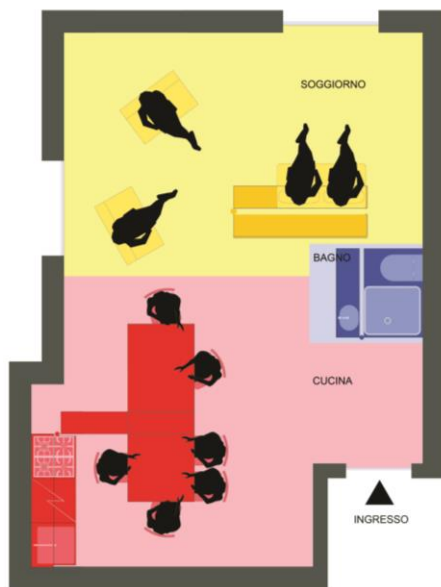

...per una festa

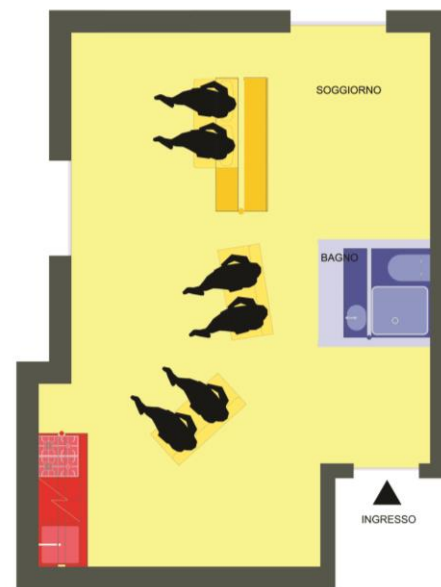

...per un film

# Sistema CONTROSOFFITTO

MODULO 1 (100 x 100 x 30)cm

alloggio climatizzatore ad incasso

MODULO 2 (100 x 50 x 20)cm

alloggio luce; elemento coprente per la parte superiore della cerniera; elemento semplice di composizione

MODULO 3 (50 x 50 x 10)cm

alloggio luce; elemento coprente per la parte superiore della cerniera; elemento semplice di composizione



# Modulo SOGGIORNO - LETTO

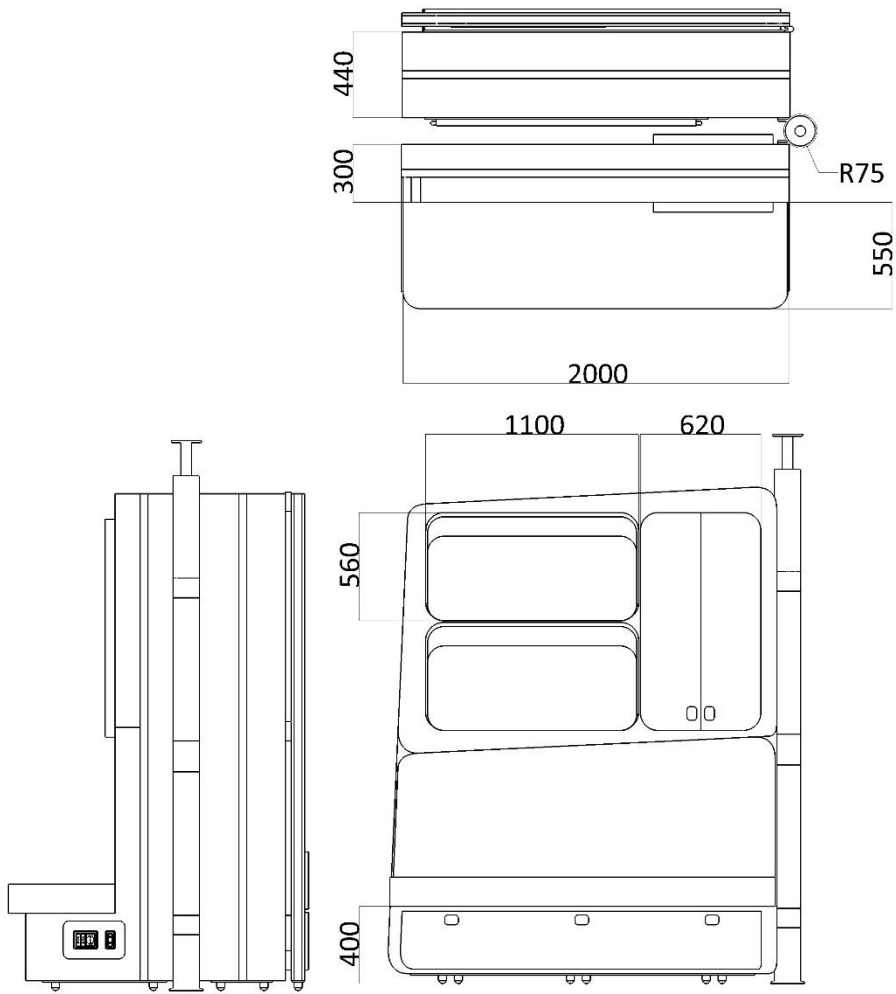

Come è fatto

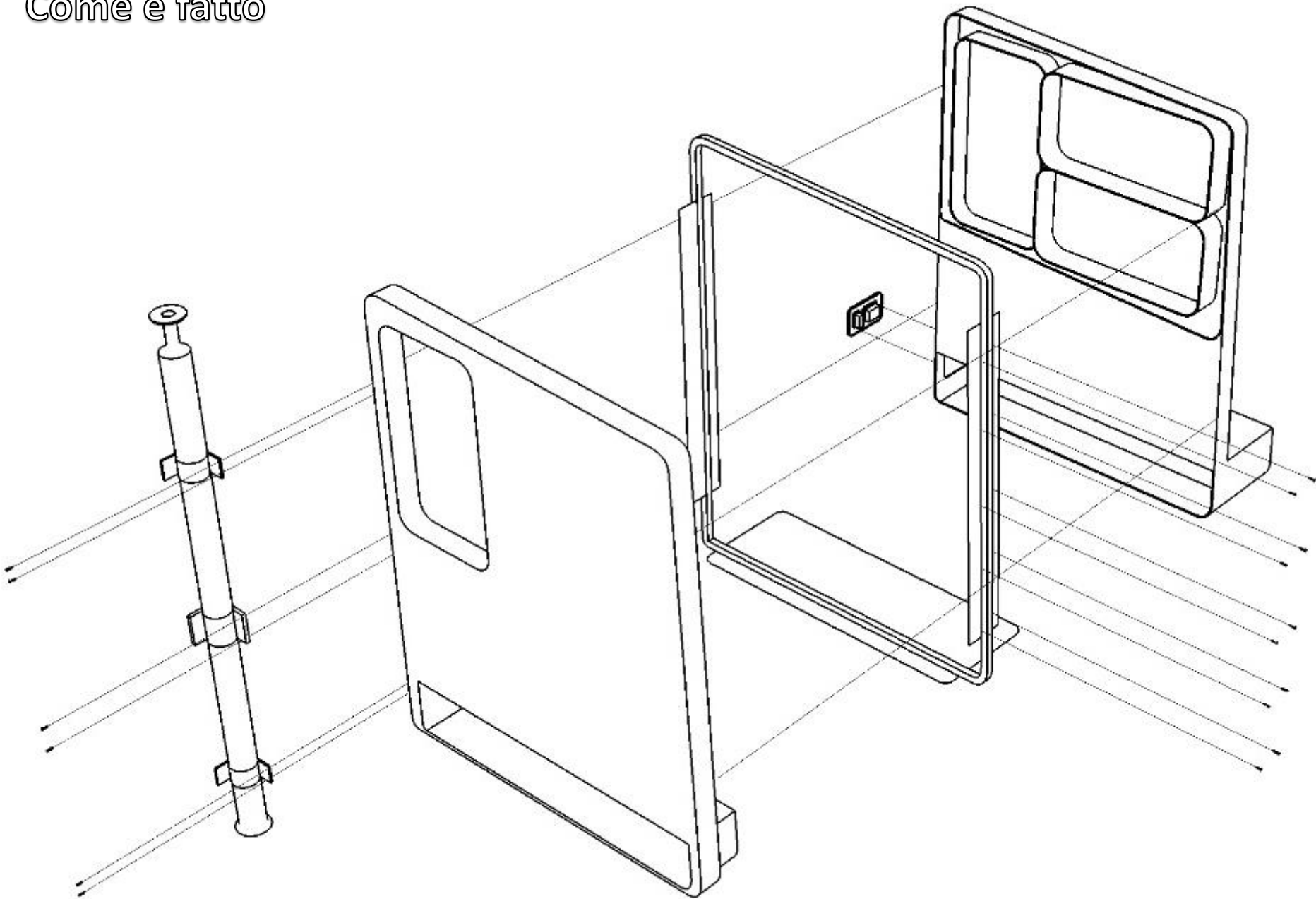

# ACCIAIO

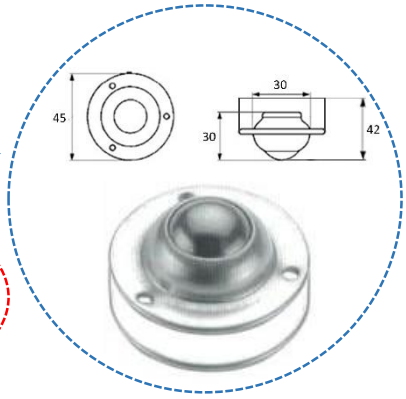
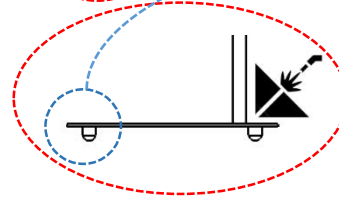
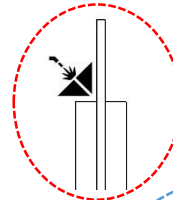
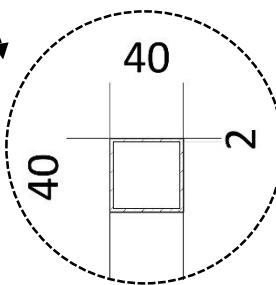
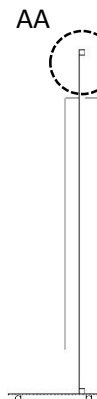
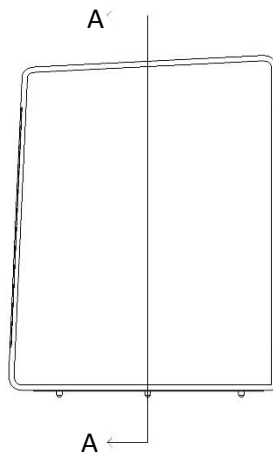
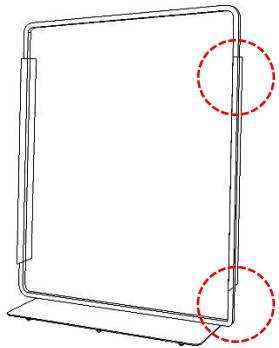

# VETRORESINA

Resina poliester + fogli di fibra di vetro



+ altri materiali (es. catalizzatore)

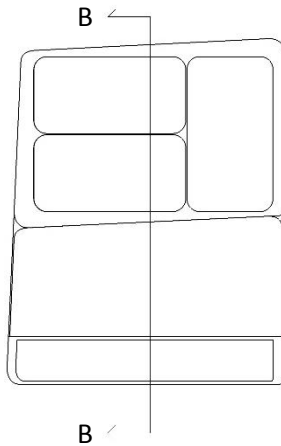
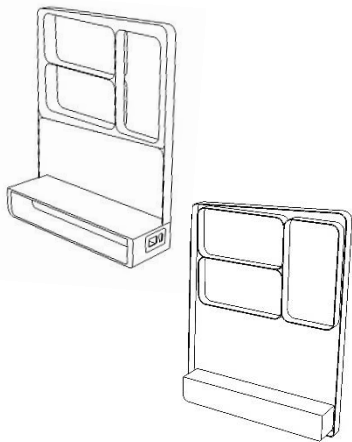

BB

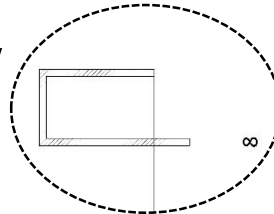
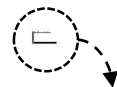

1. Chiusura degli stampi
2. Introduzione della resina
3. Vuoto regolato al centro dello stampo

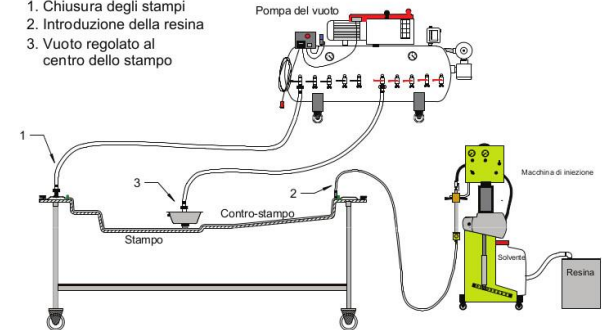

# ALLUMINIO SPAZZOLATO

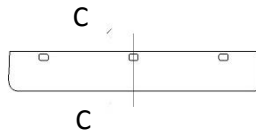
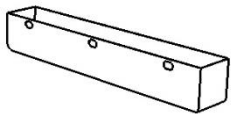

CC

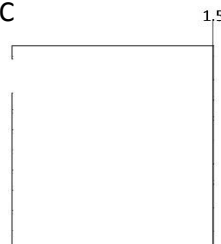

## Metodo di GIUNZIONE

Acciaio – Vetoresina

Vetoresina – Alluminio



# Percorso elettrico

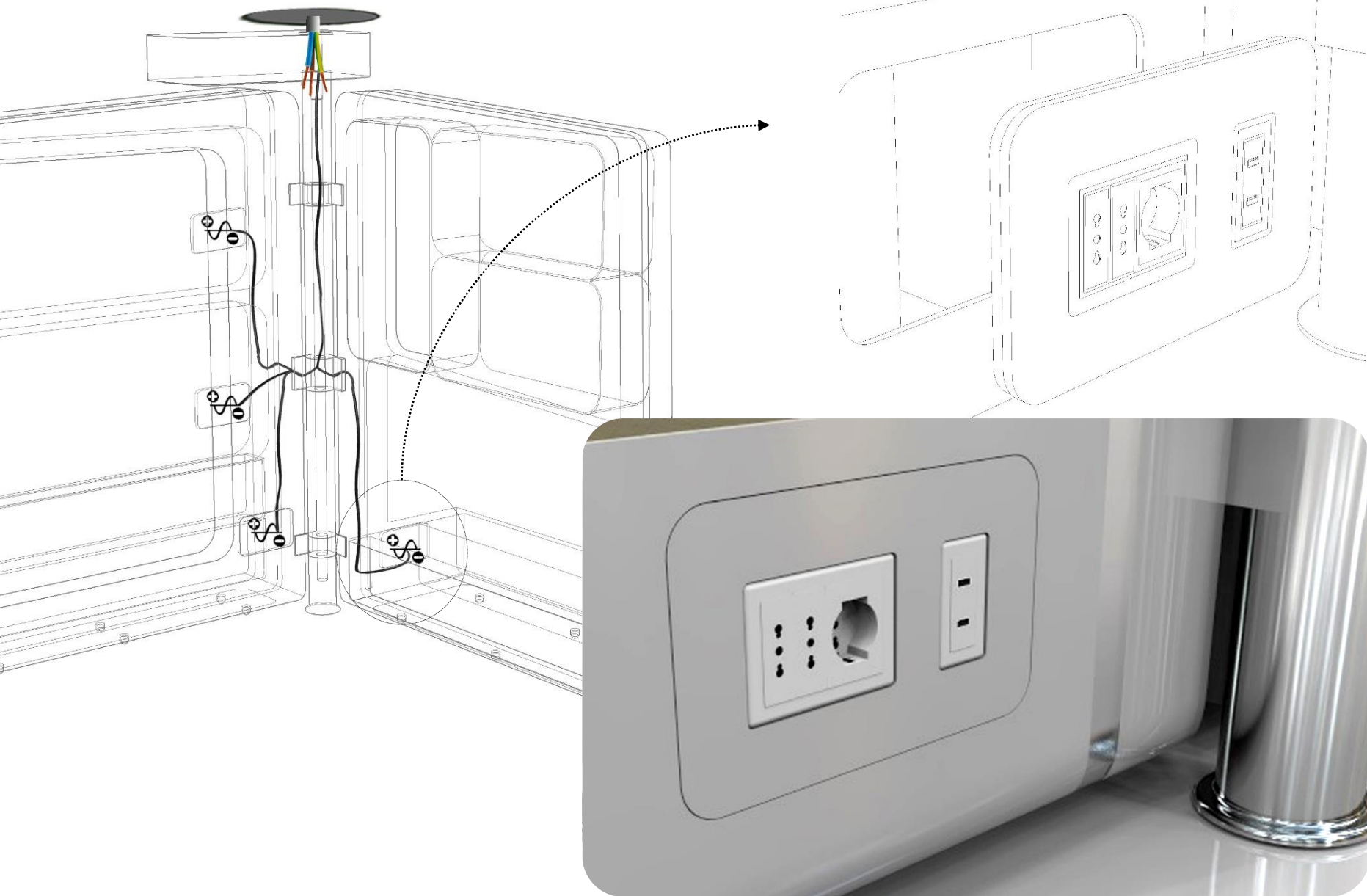



## Come funziona

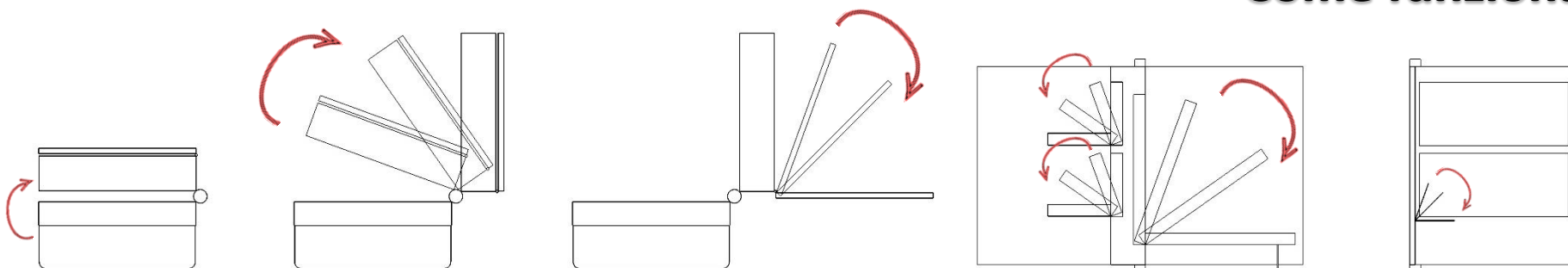

## Soggiorno e studio

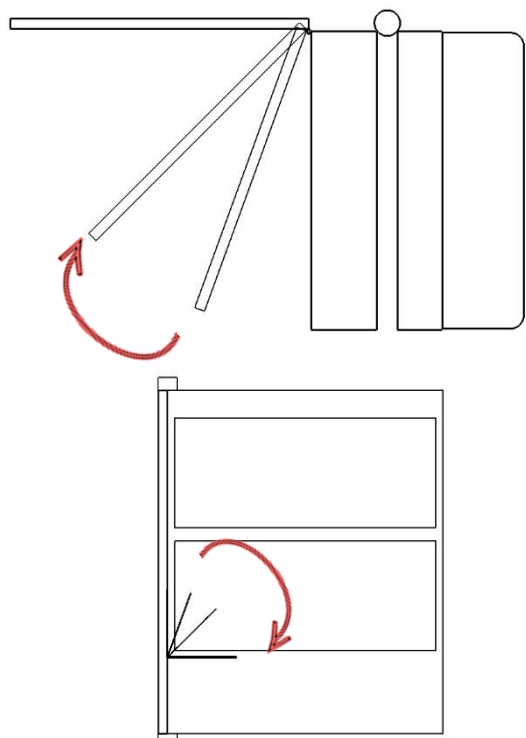

# Camere da letto

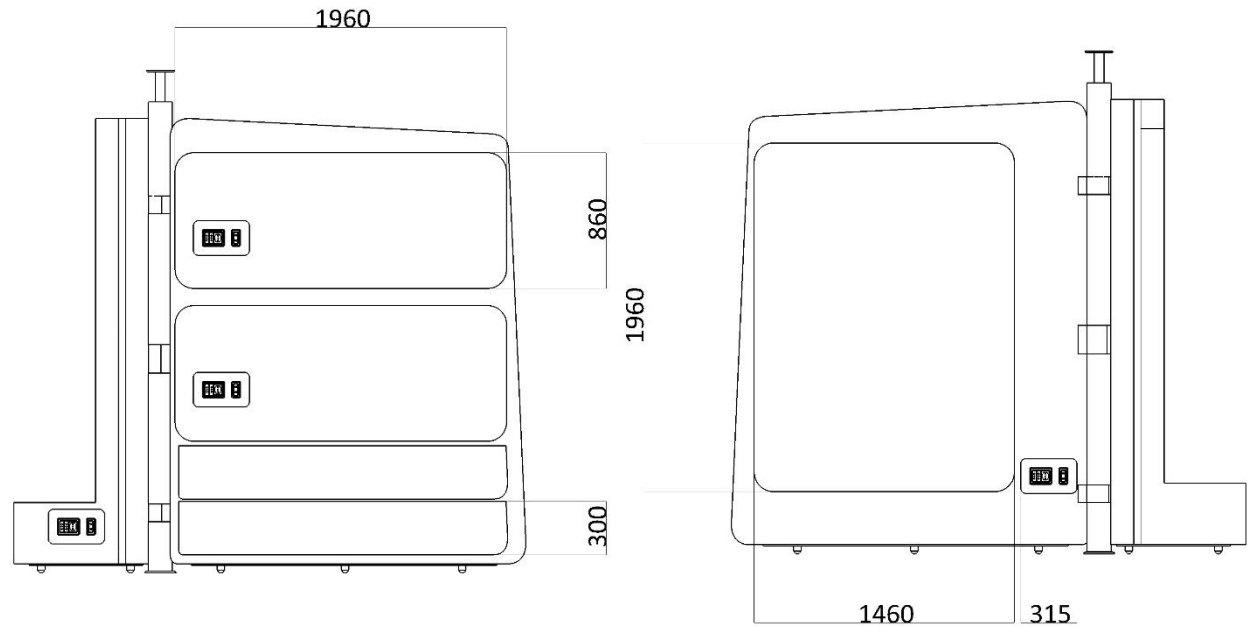
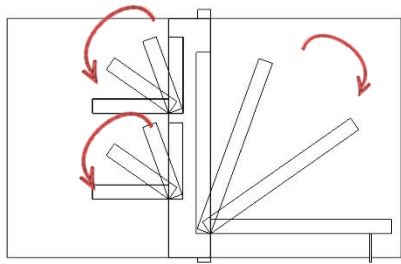
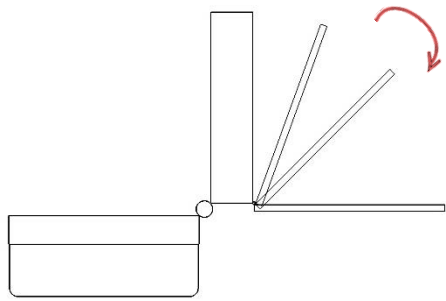

Sistema reti autoportante



# Modulo BAGNO

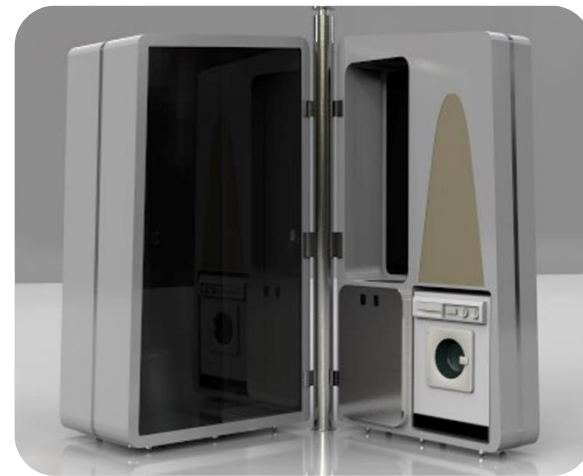
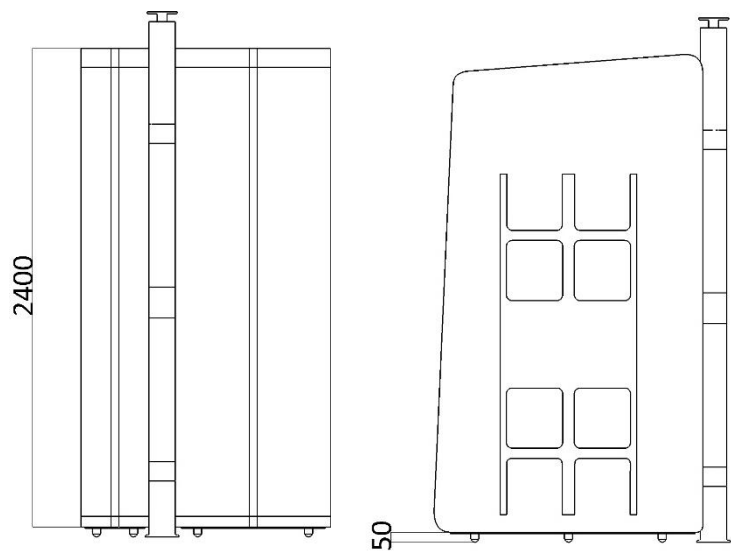
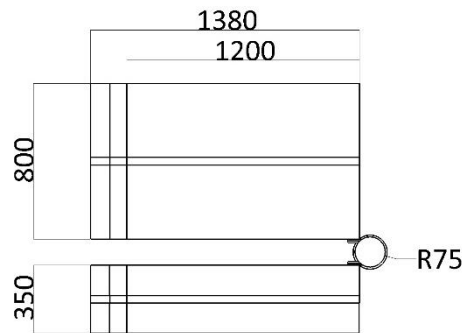

# Modulo CUCINA

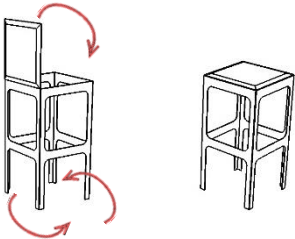
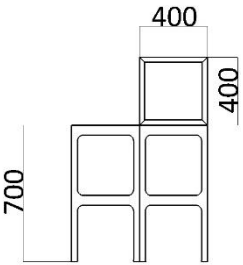
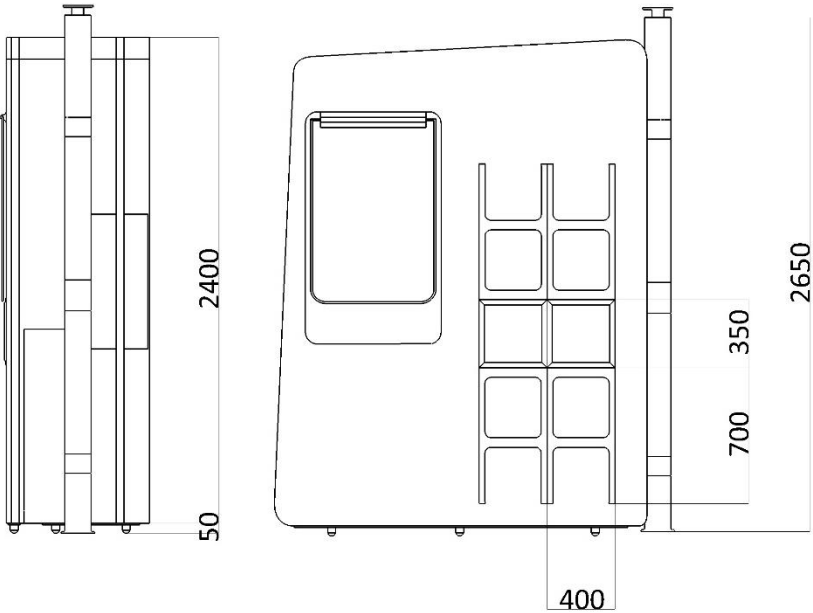
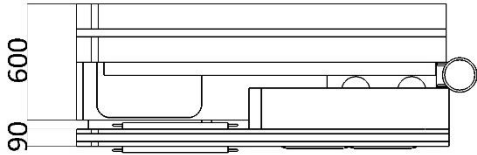

# AMBIENTAZIONI





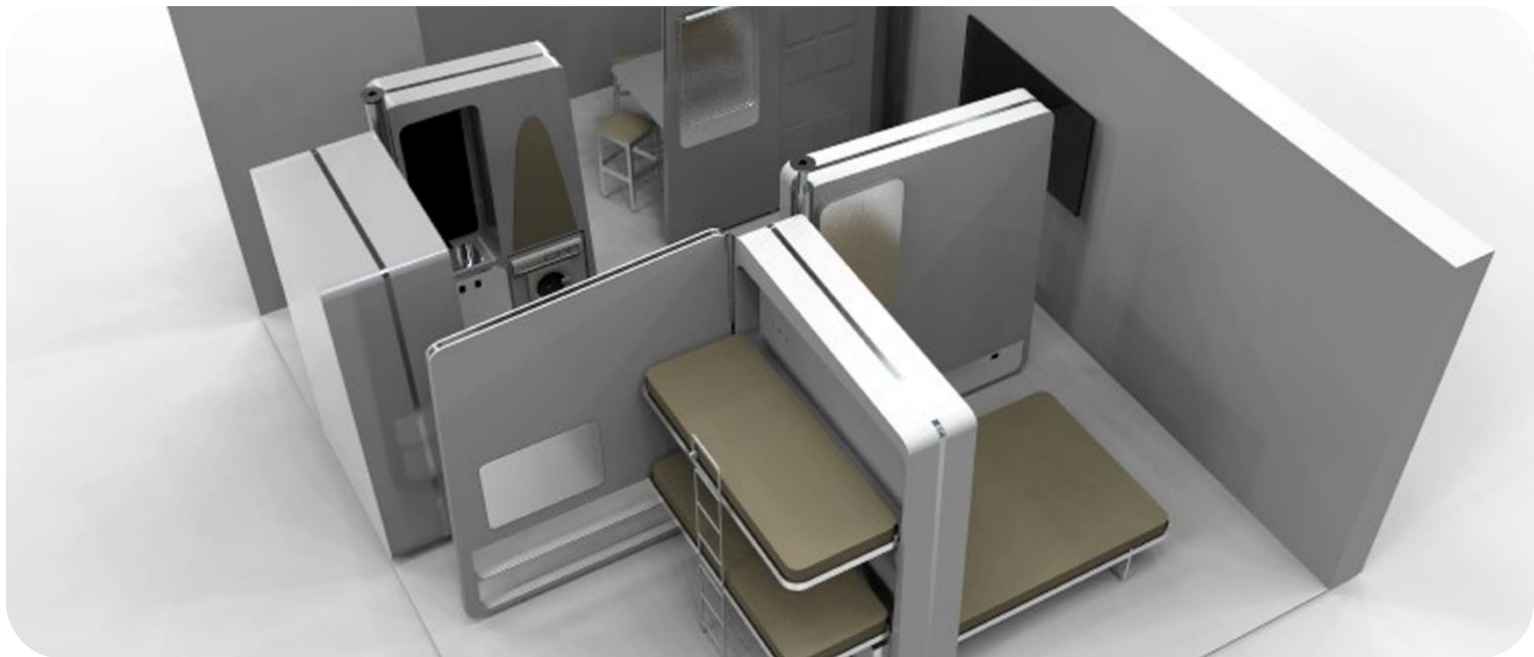
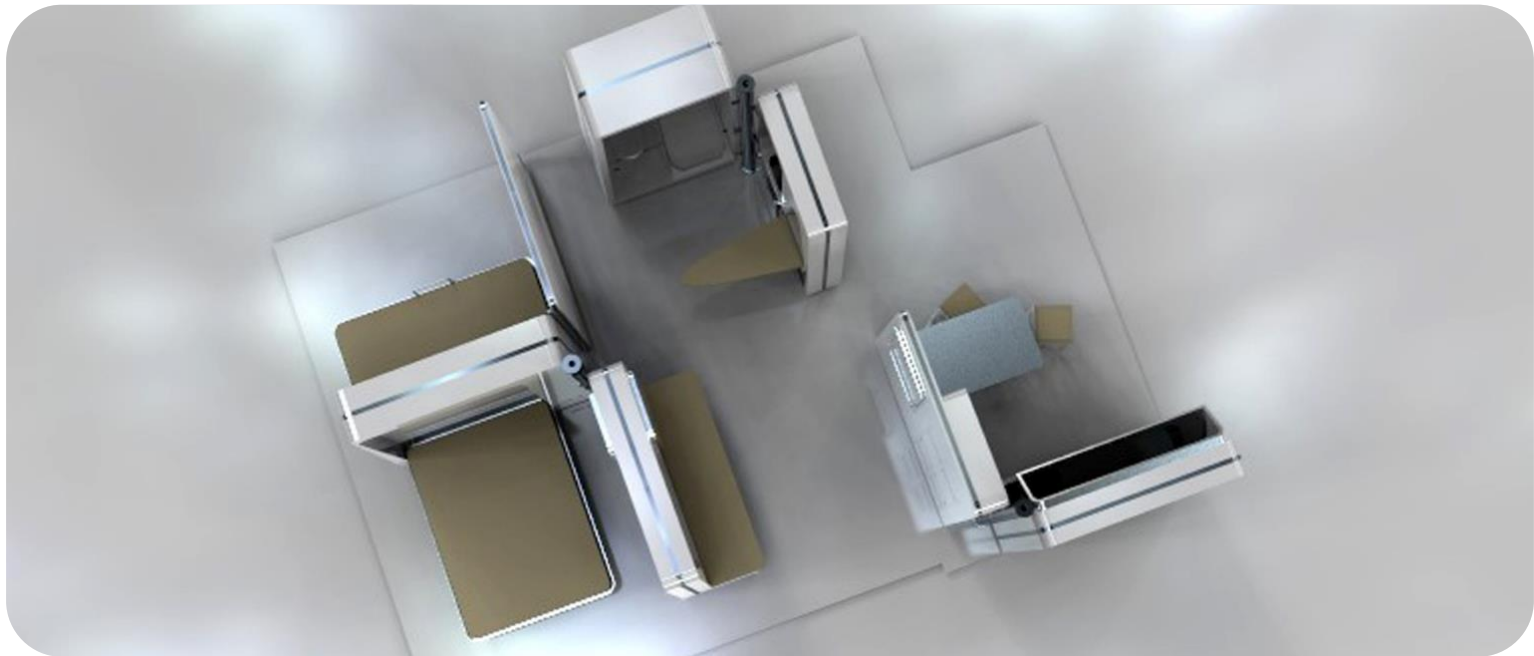

VITI → DISASSEMBLAGGIO 

ACCIAIO  
**RECYCLED**

VETRORESINA

ALLUMINIO  
**RECYCLED**





«Viviamo in un mondo in continua trasformazione.  
Siamo catapultati in un ordine globale che sta estendendo i suoi effetti su tutti noi»

DOMOTICA GREEN FLESSIBILE  
**casa del futuro**  
 MICROAMBIENTE COLLETTIVA

classificazione in base alla loro organizzazione interna

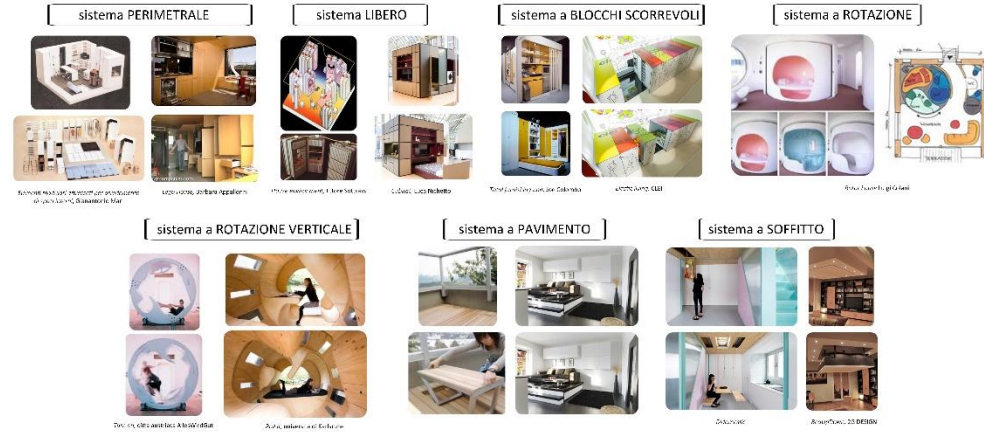

**SISTEMA MODULARE PER ALLESTIMENTO DI MICROAMBIENTI AD USO ABITATIVO**

**sistema LIBERO**

modulo CUCINA

modulo SOGGIORNO-LETTO

modulo BAGNO

sistema CONTROSOFFITTO

**MODULI TECNICAMENTE INDIPENDENTI**

Modulo 1 (100x100x30)cm  
alloggio climatizzatore ad incasso

Modulo 2 (100x50x20)cm e Modulo 3 (50x50x10)cm  
alloggio luce; elemento coprente per la parte superiore della cerniera; elemento semplice di composizione

**I MATERIALI**

**ACCIAIO**  
Scorrevole anti-ruggine

**VETRORESINA**

processo di produzione RTM (Resin Transfer molding)

**ALLUMINIO spazzolato**

**metodo di GIUNZIONE**  
acciaio-vetroresina-alluminio



## Modulo SOGGIORNO-LETTO

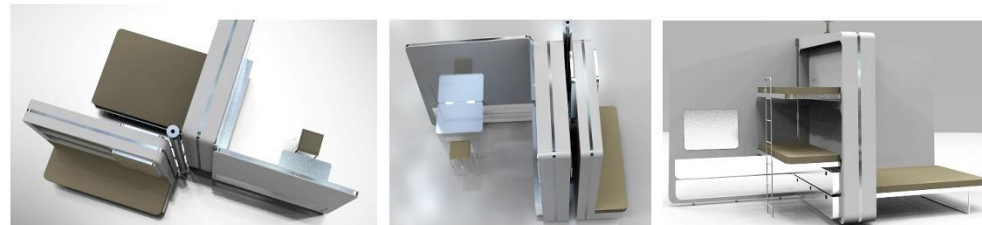
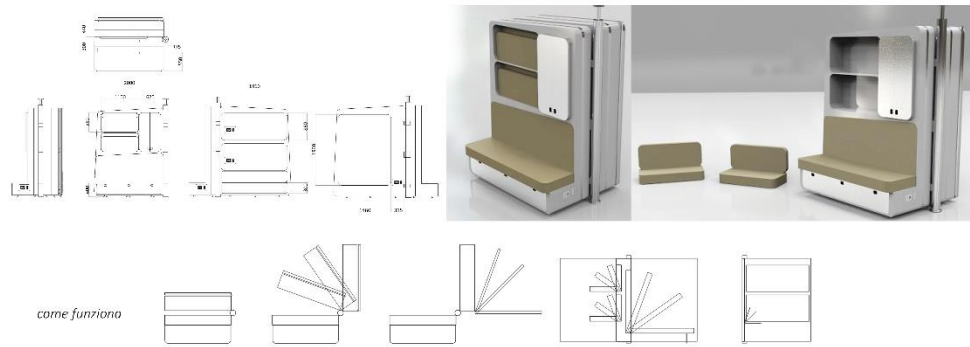

## Modulo BAGNO

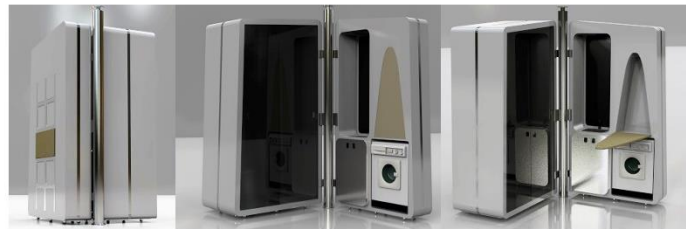
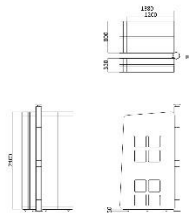

## Modulo CUCINA

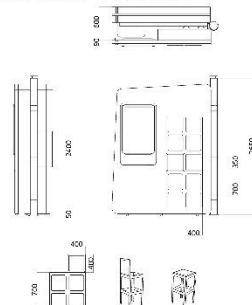

# AMBIENTAZIONI

1. giorno

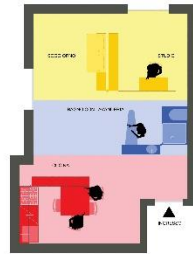

2. notte

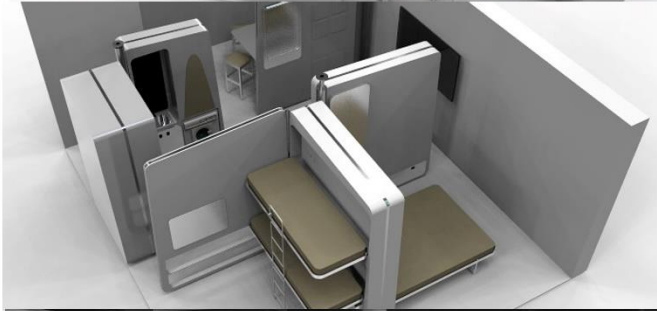

3. festa con amici

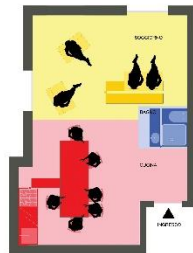

4. film con amici

